

# *ACCELERATE*

How to Get Your Church Planting  
Movement Moving Again!



## Two Steps to Prepare for the Cohort

### 1. Rename Yourself

See Example:

- Regional - Name
- National - Name

2. Download & Print Worksheets that were emailed to you.

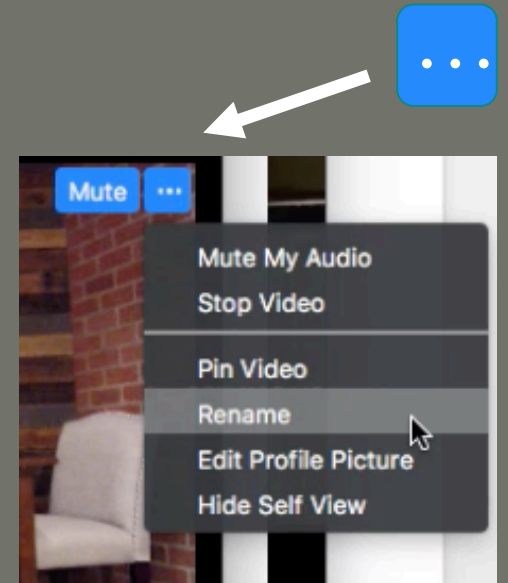

Regional - Your Full Name

**National – Gary Rohrmayer**

# Church Multiplication Partner Services

## Executive Consult

- Free Half-Day Executive Consult to assess your organizations capacity for church planting.

**FREE**

## Executive Coaching

- 10 Video Coaching Sessions
- 2 Onsite Training and Coaching Sessions
- One Free Admission to Accelerate
- Access to CMP Staff

**\$5000**

## Executive Coaching

- 12 Video Coaching Sessions
- One Free Admission to Accelerate
- Access to CMP Staff

**\$2500**

# Church Multiplication Partner Services

## Executive Consult

- Free Half-Day Executive Consult to assess your organizations capacity for church planting.

FREE

## Executive Coaching

- 10 Video Coaching Sessions
- 2 Onsite Training and Coaching Sessions
- One Free Admission to Accelerate
- Access to CMP Staff

\$5000

~~\$2500~~

## Executive Coaching

- 12 Video Coaching Sessions
- One Free Admission to Accelerate
- Access to CMP Staff

\$2500

~~\$1250~~

## If you are interested in ...

### A Free Consultation

- Contact Gary
- [info@multiplyingchurches.org](mailto:info@multiplyingchurches.org)

### A Coaching Relationship

- Contact one of our coaches through a private chat during the meeting.
- Or
- Contact Gary
- [info@multiplyingchurches.org](mailto:info@multiplyingchurches.org)

# Movement Systems

You will only expand to the capacity  
and effectiveness of your systems.



*Movement systems are  
**reproducible and  
interconnected** processes by  
which the organization  
**actualizes its values and  
achieves its mission.***



# Eight Systems for a Church Planting Movement

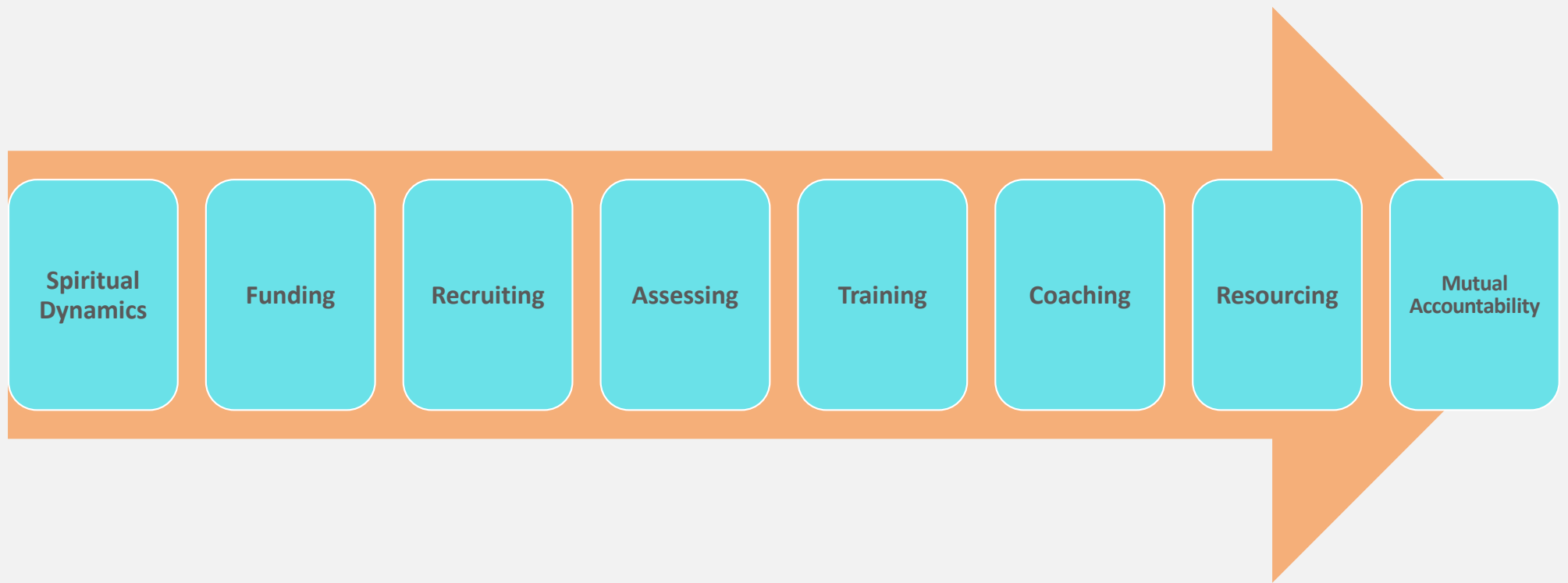





**greenhouse**  
ENVIRONMENTS

# Preparing Plants for the Field

David Reynolds  
Church Multiplication Partners  
The Alliance



# What is a Greenhouse Church?

A greenhouse provides a healthy, protective, nutritional environment for plants to grow and thrive.



# What is a Greenhouse Church?

A Greenhouse Church requires these components:

- (1) A Spirit of Willingness to “give itself away”
- (2) A Leadership Development Pathway
- (3) Faith-Filled Risk to train and send leaders



# I. A Spirit of Willingness

## Biblical Model: The Church at Antioch

ACTS 11 - Antioch sent a gift to Jerusalem

**DO SOMETHING!**

ACTS 13 - Antioch sent Paul & Barnabas, their BEST!

**SEND SOMEONE!**



## 10 ways to Help a Church Plant

1. Pray for a planter and their team.
2. Send a planting couple to dinner.
3. Invite a planter to share their vision with your church.
4. Give a church plant a one-time gift.
5. Hold a “baby shower” for a church plant.
6. Loan your facility to a church plant.
7. Financially support a plant for a year or more.
8. Send people from your church to serve for a season.
9. Partner with other churches to plant a church.



# I. A Spirit of Willingness

## Denominational Example: Your Tribe's History

- Many denominations began with one church
- Appeal to your own history...

*“Where will the next great movement of God come from, and why not your church?”*



# II. A Leadership Development Pathway



# II. A Leadership Development Pathway

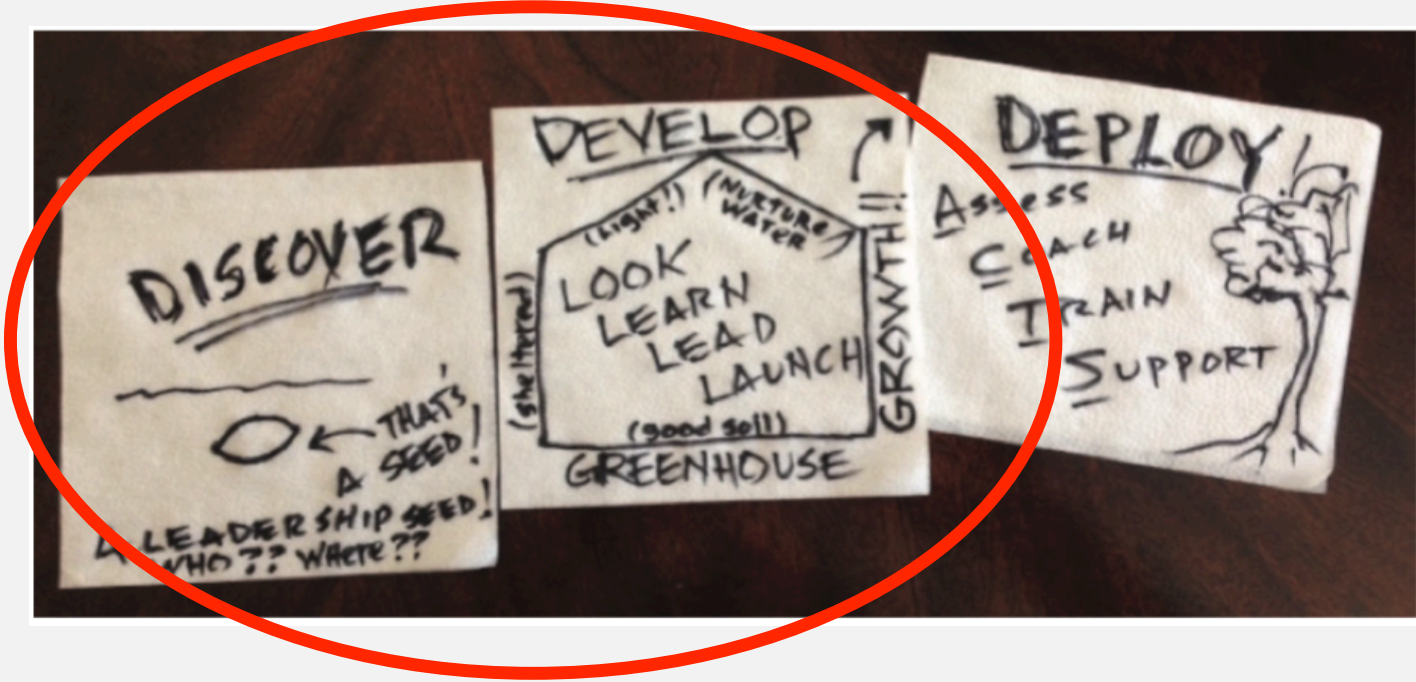

Local Churches



		YEAR 1		YEAR 2		YEAR 3	
<b>LEARNING METHOD</b>		<b>LOOK</b> at healthy ministry	<b>LEARN</b> practical ministry skills	<b>LEAD</b> established ministry	<b>LAUNCH</b> newministry & hand off	<b>PLAN</b> vision, values, strategy, & structure	<b>PREPARE</b> team
<b>CREDENTIALING EDUCATION</b>	<b>PLACEMENT 1 DAY ASSESSMENT</b> (online tests & interview)	Licensing & Ordination with District of potential plant location				Ordination	
		30 hrs Bible/Theology thru College, Seminary, MSP, Online				Education completed	
<b>PRAYER</b>		Observe prayer in action	Practice prayer, presence, & listening in own life	Guide people in practicing prayer, presence, & listening	Train someone else to lead others in prayer experience	Pray and listen for God's plans	Pray together
<b>TEACHING</b>		Learn under quality teachers	Teach small group	Teach large group	Preach as part of church series	Develop preaching calendar	Missional preaching
<b>COACHING</b>		Discipleship Coaching & Spiritual Formation	Coaching in Basic Ministry Skills	Leadership Coaching	Leadership Coaching	Church Planting Coach	Church Planting Coach
<b>TEAMWORK</b>		Observe team in planning & action	Participate in a team around own gifting/calling	Lead a ministry team	Establish a newministry team	Recruit & assemble church plant team	Lead team to implement vision & strategy
<b>SMALL GROUP</b>		Participate in small group/missional community	Apprentice in small group/MC	Lead small group/MC	Start a new small group/MC	Start incarnational group in area of church plant	Grow & multiply incarnational group
<b>INCARNATIONAL</b>		Participate with others on	Befriend and interact with	Actively share Christ with	Involve unbelievers /	Learn & understand	Befriend and interact with
		<b>CHURCH PLANTING ASSESSMENT CENTER (4 Day)</b>					



# III. Faith-filled Risk to Send Out Church Planters



Denominational

# III. Faith-Filled Risk to Send Planters

## Denominational Support:

Assessment  
Coaching  
Training  
Support



# Interview with Dr. Ed Love

Director of Church Multiplication  
The Wesleyan Church



# Breakout Time

Have your worksheet  
ready to work on.



Take 10  
minutes at the  
beginning of  
the breakout  
time to fill out  
the worksheet.

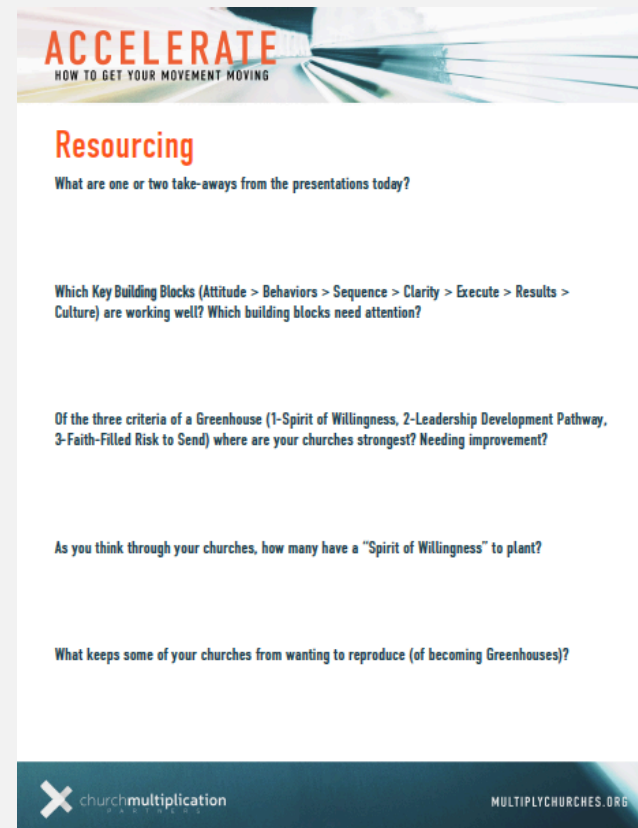

**ACCELERATE**  
HOW TO GET YOUR MOVEMENT MOVING

### Resourcing

What are one or two take-aways from the presentations today?

Which Key Building Blocks (Attitude > Behaviors > Sequence > Clarity > Execute > Results > Culture) are working well? Which building blocks need attention?

Of the three criteria of a Greenhouse (1-Spirit of Willingness, 2-Leadership Development Pathway, 3-Faith-Filled Risk to Send) where are your churches strongest? Needing improvement?

As you think through your churches, how many have a "Spirit of Willingness" to plant?

What keeps some of your churches from wanting to reproduce (of becoming Greenhouses)?

 churchmultiplication

MULTPLYCHURCHES.ORG

# Breakout Time



# Quick Fire Reports

Share insights from each  
Breakout





# Leadership Reflection

What are the three “one win” you need to have this week to see your resourcing system move to the next level this month?

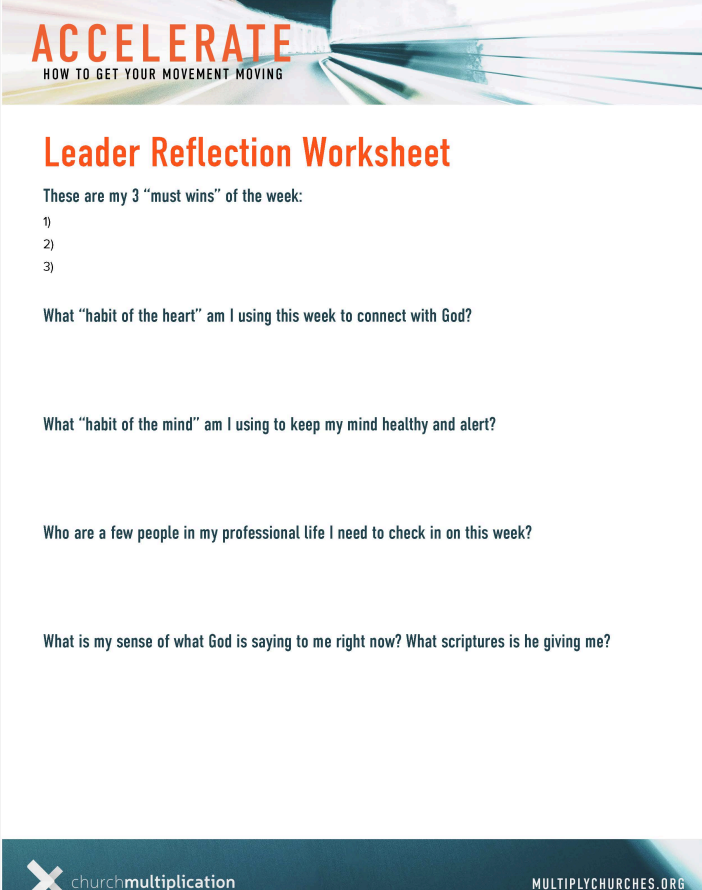

**ACCELERATE**  
HOW TO GET YOUR MOVEMENT MOVING

## Leader Reflection Worksheet

These are my 3 “must wins” of the week:

- 1)
- 2)
- 3)

What “habit of the heart” am I using this week to connect with God?

What “habit of the mind” am I using to keep my mind healthy and alert?

Who are a few people in my professional life I need to check in on this week?

What is my sense of what God is saying to me right now? What scriptures is he giving me?

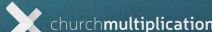
 churchmultiplication

MULTPLYCHURCHES.ORG

## If you are interested in ...

### A Free Consultation

- Contact Gary
- [info@multiplyingchurches.org](mailto:info@multiplyingchurches.org)

### A Coaching Relationship

- Contact one of our coaches through a private chat during the meeting.
- Or
- Contact Gary
- [info@multiplyingchurches.org](mailto:info@multiplyingchurches.org)

# Join us next week

As we look are Funding for  
Multiplication during  
COVID.

